

FLOOR PLAN NOTES:

DOOR HANDLES

-ALL DOORS TO HAVE LEVERED TYPE HANDLES.

ACOUSTIC CEILING

-EXISTING ACOUSTIC CEILING TO REMAIN.
 -ACOUSTIC CEILINGS TO BE REPAIRED WHERE WALLS ARE ADDED OR REMOVED.

LIGHTING

-"OC" DENOTES OCCUPANCY SENSORS
 -ALL LIGHTING FIXTURES TO REMAIN AS IS WITH NO CHANGES.

EXIT SIGNS

-"EX" DENOTES EXIT SIGN.
 -"CP" DENOTES EXIT & EMERGENCY LIGHTING COMBINATION PACK.
 -"EL" DENOTES EMERGENCY LIGHTING

RESTROOMS

-ALL RESTROOMS TO REMAIN AS IS WITH NO CHANGES

PLUMBING

-ADDITION OF CHILD HEIGHT TOILETS & SINKS IN 2-3 Y/O KIDS ROOM
 -ADDITION OF WASHER IN LUNCHROOM
 -ADDITION OF 2 DISHWASHERS & SINK IN FOOD WARMING AREA
 -ADDITION OF CABINET SINKS IN INFANTS ROOM, PRESCHOOL ROOM, & 4-5 Y/O KIDS ROOM.
 -ADDITION OF WATER HEATER AND MOP SINK IN MECHANICAL ROOM.
 -ADDITION OF WALL HUNG SINK IN CHANGING STATION #1 & #2

HYAC

-ALL HYAC TO REMAIN AS IS WITH NO CHANGES.

GLAZING

-ALL GLAZING FOR INTERIOR VIEW WINDOWS TO BE TEMPERED.

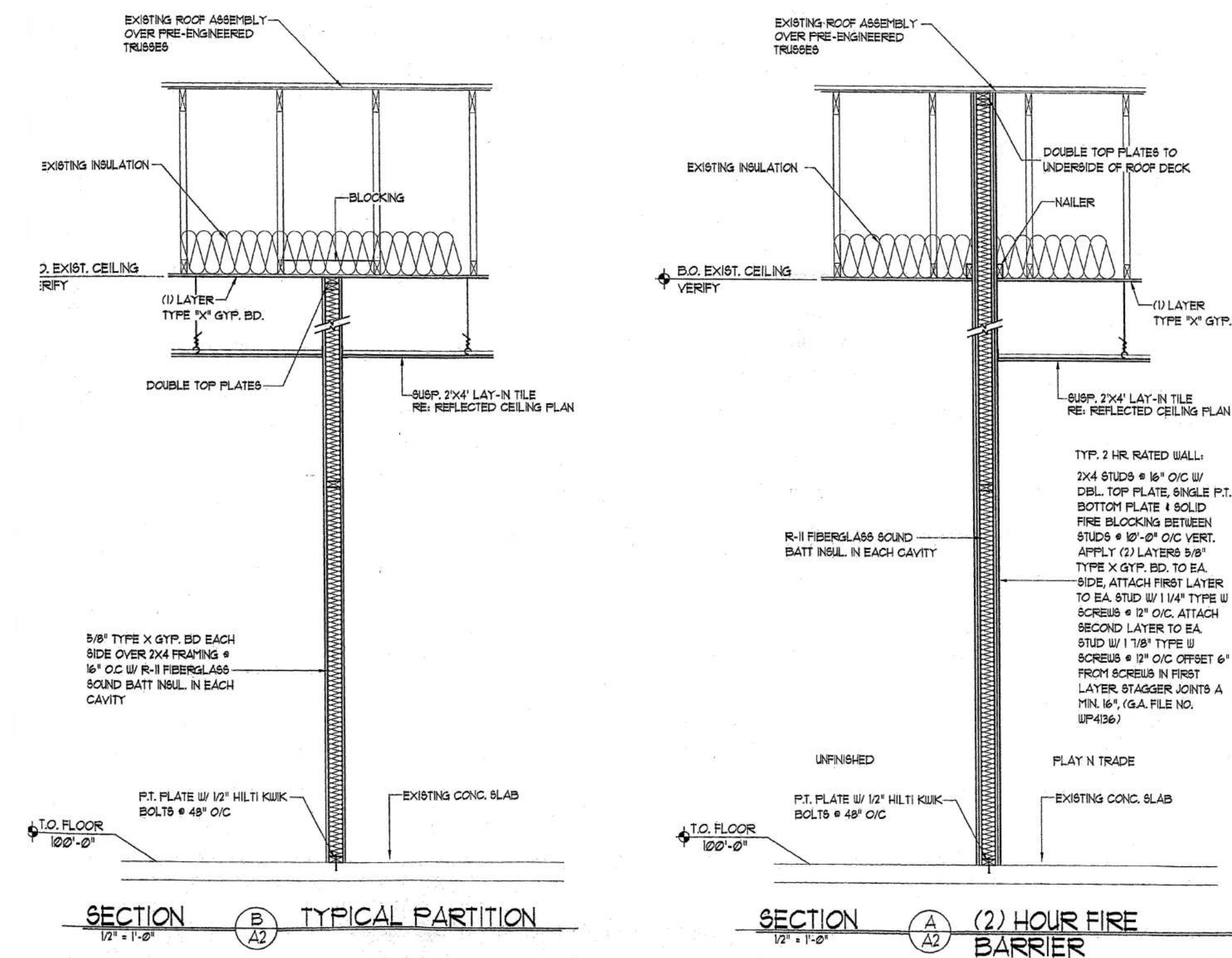

NOT FOR CONSTRUCTION UNLESS SIGNED

DRAWING REVISION
 DATE 3/5/2019 02:31 PM

DRAWING START DATE
 DATE 2/14/19

OWNERS SIGNATURES _____

BUILDERS SIGNATURES _____

SKIDMORE
 60 YEARS
 SINCE 1958

PROJECT ADDRESS:
 1818 HOOPER AVE
 IDAHO FALLS, ID 83404

NEW TI FOR:
 PAPA BEAR DAYCARE

DRAWN BY: BRAXTON SKIDMORE
 208-528-3672 WRK.
 208-716-4611 MBL.
 braxton@skidmoreinc.com
 skidmoreinc.com WEB
 LIKE US ON FACEBOOK

OFFICE ADDRESS:
 3820 EAST SUNNYSIDE RD.
 IDAHO FALLS, ID.
 208-528-3672

JOB # _____

SHEET
 3 OF 4